

General Geo Washington

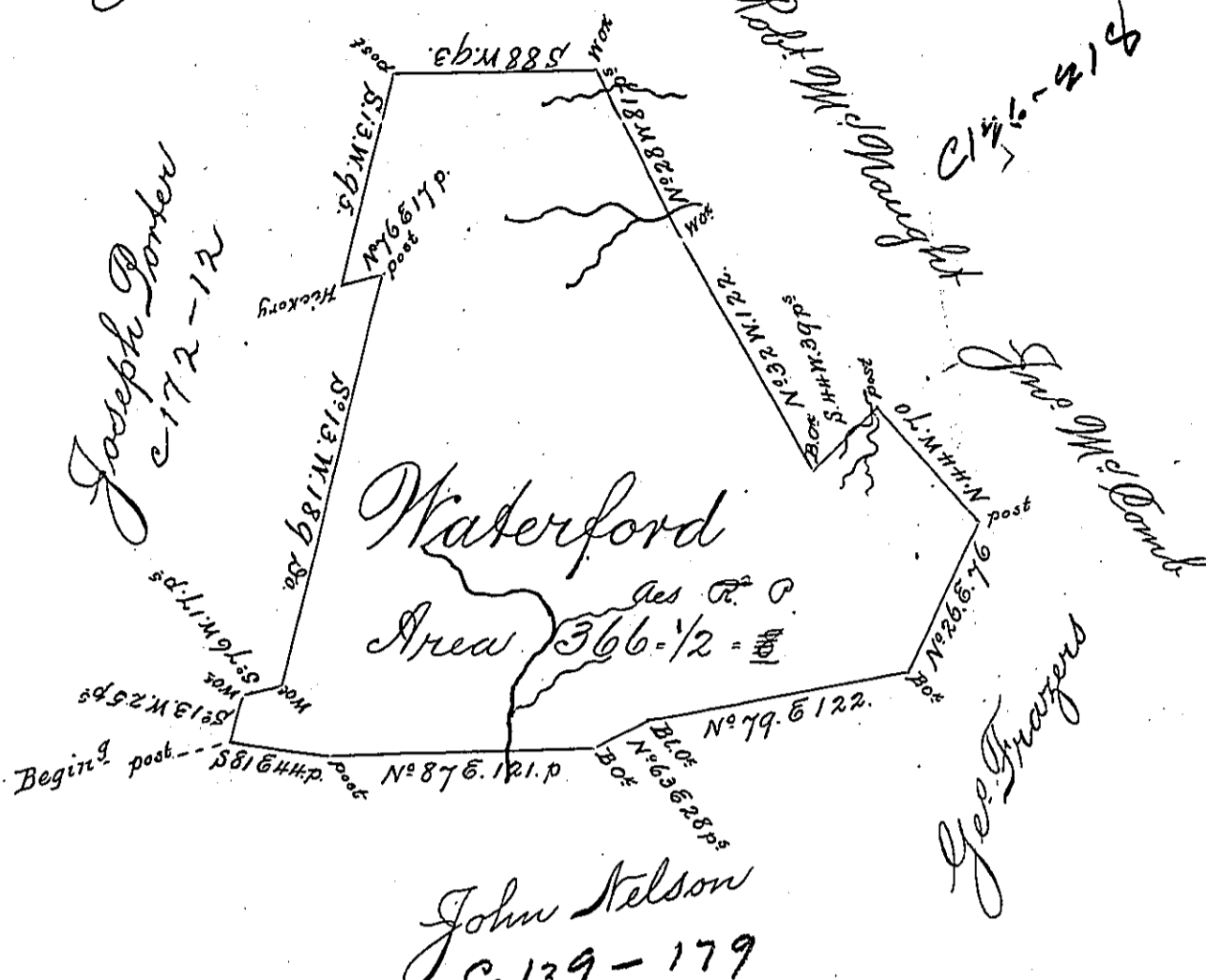

Waterford

Area 366 1/2 = 366

John Nelson
C 139 - 179

The above is a Draught of a Tract of Land called
 Waterford, lying on the waters of Shirtee Creek contain-
 ing 366 Ac² 2 ¹/₂ ⁰/₁₀₀ with the usual allowance for Roads &c
 Surveyed in pursuance of a Warrant dated Phil^a
 Feb. 9th 1785 for Rob. Guttry
 July 20th 1785

Presley Nevill }
 Matt. Ritchie } Df

To Gen^l Lukens Esq^t

IN TESTIMONY that the above is a copy of the original remaining on file in
 the Department of Internal Affairs of Pennsylvania, made
 conformably to an Act of Assembly approved the 16th day of
 February, 1833, I have hereunto set my Hand and caused
 the Seal of said Department to be affixed at Harrisburg,
 this Seventh day of May 1901.

James W. Latta
 Secretary of Internal Affairs.